

magnetU

Ready, Setup, Go

Start Here

Welcome to magnetU. This Quick Start guide tells you how to set up your magnetU and use its key features.

**IMPORTANT:** DO NOT PLUG IN MAGNETU TO YOUR PC BEFORE YOU DOWNLOAD THE MAGNETU APPLICATION TO YOUR PC AND FOLLOW THE “READY, SETUP, GO” STEPS BELOW.

IT IS A MUST TO FOLLOW ALL STEPS AND PASS THEM SUCCESSFULLY BEFORE YOU CAN USE MAGNETU.

We recommend downloading the latest magnetU Guide from [www.magnetU.com/manuals/magnetUGuide.pdf](http://www.magnetU.com/manuals/magnetUGuide.pdf)

1. Download and install magnetU software. Go to [www.magnetU.com](http://www.magnetU.com), click ‘Access your Social desires’ and follow the 3 guiding steps.

Step01 - Install the magnetU software on your computer.

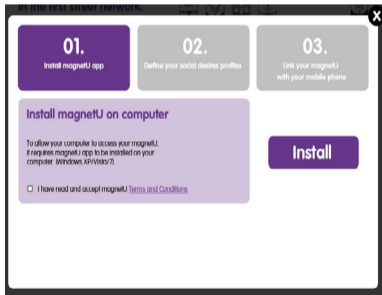

2. Step02 - stick magnetU to computer.  
Connect your magnetU device to a USB port on your computer and let the driver installation to finish. Then click "Put on your social desires".

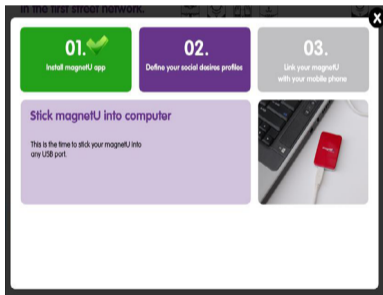

4

3. Wear your magnetU social desires profile.

Select the social desires profile you want to use, complete defining your magnetU social desires profile and click SAVE CHANGES.



5

# Link your magnetU with your mobile phone - Step03

## 1. Prepare your phone.

\* Having Android or Blackberry phone? Go to Android or Blackberry markets, search for 'magnetU' and install it on your phone before continuing.

\* Turn on Bluetooth® on your phone.

## 2. Prepare your magnetU.

Press and hold the cheers button for about 10 seconds until the LED flashes RED + PURPLE. This indicates your magnetU is ready to link with your phone.



3. Make the Bluetooth® connection.  
Go to your phone's Bluetooth® settings.

#### ADD OR SEARCH FOR DEVICES

When "magnetU" appears, select it

IF ASKED FOR A PASSCODE, enter "1234"

ALLOW AUTOMATIC BLUETOOTH  
CONNECTIONS FOR THE MAGNETU  
DEVICE.

Click the NEXT button on the website.

This was a one-time event you should not  
have to repeat, unless you are connecting  
your magnetU to a new phone.

Security - Confirm  
your mobile phone  
number

To complete the first time set up and helping us establish your identity, magnetU verifies the mobile phone number you typed. You shall receive a text message to your mobile with a confirmation code. The code confirmation can be received only if you successfully linked your phone with your magnetU. Enter the code when you are asked for in Step03.

**NOTE:** For text message confirmation code, and magnetU social match text messages, your cellular operator rate applies.

The time to receive the confirmation code also depends on your cellular operator (usually very fast. In rare cases, may take several minutes). Please be patient.

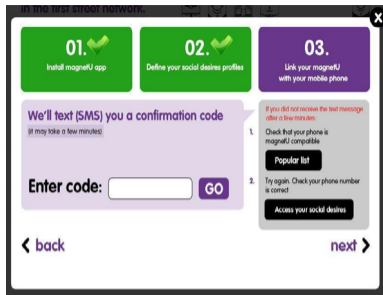

If you have waited a few minutes but didn't receive the confirmation code, please see the next page.

What to check if you have not received the text message with the confirmation code.

- Make sure the mobile number you typed is correct
- Make sure your phone is in a Bluetooth range with magnetU (less than 10 meters)
- Verify your magnetU is linked over Bluetooth with your mobile phone
- Make sure you followed and successfully completed the previous steps
- If the above are ok, check if your phone includes Bluetooth DUN (Dial-Up-Network) Profile. Such information can be found in the phone user manual, phone specification or on the web.

If you have tried to do all the above, but still didn't get the code message, please contact [support@magnetU.com](mailto:support@magnetU.com).

## magnetU cheers

You can use magnetU cheers immediately, even before defining your social desires profile, and without a mobile phone.

You are in the real-life social world, you like a person and want to add each other as a new friend to your facebook or other?

Quickly press the cheers button on your magnetU, you will notice a purple-blue blinks. You now have about 15 seconds to make cheers with people you like. Simply make a cheers gesture with another magnetU while the back of each magnetU touches each other.

You got constant blue led - you successfully cheered each other. Got red? cheers again.



You can always cheers, whether you are in "in" or "out" mode.

Your magnetU remembers hundreds of cheered bodies. Now bring all of them to your online social networks. See how in the next page.

## Add your matched and cheered friends to your online social networks

Your matched and cheered friends are kept in your magnetU. You may get tens and even hundreds of social matches and cheered friends when you are spending time in your favorite places.

First, go to your profile section in magnetU.com and define your cheers profile.

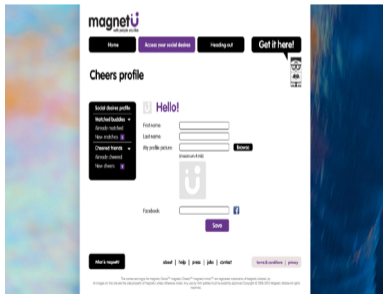

18

To view your socially matched buddies and cheered friends and also add them to your online social networks, connect your magnetU to your computer, then select 'Access ur social desires' and go to new matches or new cheers. Click the upload button. This will synch your magnetU device with your magnetU web account.



19

At this point your magnetU is partially charged and ready for use.

Take your magnetU in your pocket, bag, coat or on a key chain. Slide your magnetU into "in" and start having fun and a real cool experience, wear your social desires and start magnet people you like. And when you like a person, cheers each other.

While battery is empty, it takes 60 minutes to get your magnetU 80% charged. A full charge takes 90 minutes.

In case you require to switch off your magnetU, press the cheers button for about 5 seconds. To turn it on, press cheers for at least 3 seconds. When you are in "out" mode, you are invisible to others in the network and can use magnetU cheers only. Go out and remember to slide your magnetU into "in".

## Get More of Your magnetU

From time to time magnetU releases new versions to let you experience more with your magnetU. While you update your magnetU social desires profile, your magnetU is automatically being updated with the latest version.



Learn more.

Learn even more about magnetU features at [www.magnetU.com](http://www.magnetU.com)

For downloadable versions of magnetU Guides, visit [www.magnetU.com/manuals/magnetUGuide.pdf](http://www.magnetU.com/manuals/magnetUGuide.pdf)

and [www.magnetU.com/manuals/magnetULED.pdf](http://www.magnetU.com/manuals/magnetULED.pdf)

©2010 MagnetU Mobile Ltd. All rights reserved. magnetU, the magnetU logo, magnetU cheers, social desires, pass-it-on are trademarks of MagnetU Mobile Ltd. Other product and company names mentioned herein may be trademarks of their respective companies.